



# MODEL DUC4N DUAL CHECK VALVE 4N-300 SERIES

Job Name:	Contractor:
Job Location:	P.O. Number:
Engineer:	Representative:
Tag:	Wholesale Distributor:

## SPECIFICATIONS

The Apollo® Model DUC4N (4N-300 Series) Dual Check Valve prevents backflow by either backpressure or back-siphonage from a cross-connection between potable water lines and substances that are objectionable, but not health hazards.

## FEATURES

- Low pressure loss
- Corrosion resistant
- Replaceable check modules
- Available in standard and swivel connections
- MADE IN THE USA



## MATERIAL SPECIFICATIONS

Part Name	Material
Body	Bronze C84400
Tailpiece & Union Nut	Brass C36000
Check Modules	Glass-Filled Noryl® (3/8"-1/2") Acetal (3/4"-1")
Springs	Stainless Steel
Seat Discs	EPDM (3/8"-1/2") Buna-N (3/4"-1")

## ORDERING INFORMATION

4N - 3 X X - X X - X

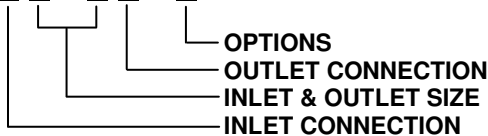

### INLET CONNECTION<sup>1,3</sup>

- |   |  |
|---|--|
| <input type="checkbox"/> A - FNPT           | <input type="checkbox"/> E - Male Meter Thd    |
| <input type="checkbox"/> B - MNPT           | <input type="checkbox"/> S - Female Mtr Swivel |
| <input type="checkbox"/> C - Female Mtr Thd | <input type="checkbox"/> 2 - Female BSPP       |

### SIZE<sup>2</sup>

- |                                   |                                   |                                     |
|-----------------------------------|-----------------------------------|-------------------------------------|
| <input type="checkbox"/> 2 - 3/8" | <input type="checkbox"/> 4 - 3/4" | <input type="checkbox"/> 6 - 1 1/4" |
| <input type="checkbox"/> 3 - 1/2" | <input type="checkbox"/> 5 - 1"   |                                     |

### OUTLET CONNECTION<sup>1,3</sup>

- |   |   |
|---|---|
| <input type="checkbox"/> A - FNPT           | <input type="checkbox"/> E - Male Meter Thd |
| <input type="checkbox"/> B - MNPT           | <input type="checkbox"/> F - Female BSPP    |
| <input type="checkbox"/> C - Female Mtr Thd |   |

### OPTION

- C - Rough chrome plated (3/8" size only)

Example: 4N-3S5-4A = 1" female meter swivel inlet (for connection to a 3/4" water meter) x 3/4" FNPT outlet.

Notes:

<sup>1</sup>For meter threads, order one size larger than meter size.

<sup>2</sup>1 1/4" is only available for the Female Meter Swivel Connection.

<sup>3</sup>Not all inlet and outlet combinations are available. Please contact Conbraco Customer Service for availability.



## APPROVALS

ASSE® 1024 and CSA® B64.6

## PERFORMANCE RATING

Maximum Continuous Operating Pressure 175 psi  
Temperature Range 33 °F – 180 °F

## DIMENSIONS (in.) – WEIGHTS (lbs.)

Size	A	B	Wt.
3/8" & 1/2"	3.32	1.88	0.70
3/4"	4.38	2.00	1.40
3/4" Meter Swivel	4.75	2.00	1.60
1"	4.38	2.00	1.40
1" Meter Swivel	4.75	2.00	1.75

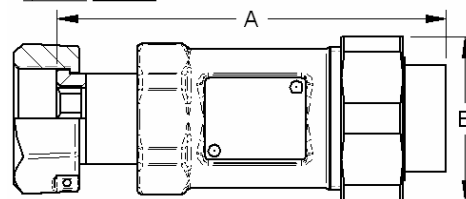
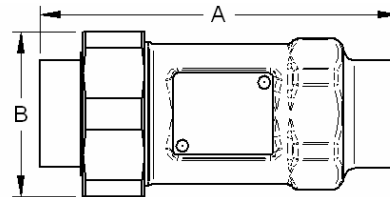

## FLOW CURVES

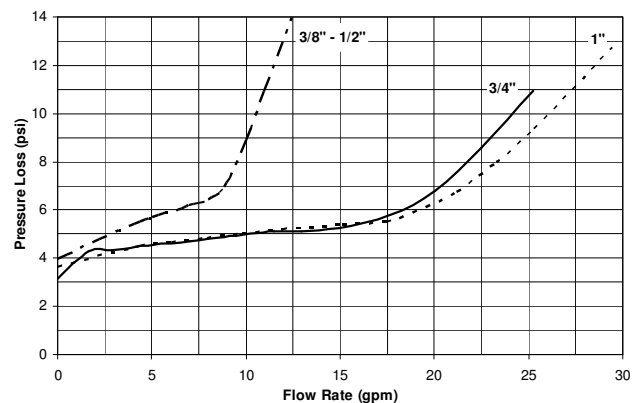

Conbraco Industries, Inc. 701 Matthews Mint Hill Rd. Matthews NC 28105 USA; [www.apollovalves.com](http://www.apollovalves.com); 704-841-6000

This specification is provided for reference only. Conbraco reserves the right to change any portion of this specification without notice and without incurring obligation to make such changes to Conbraco products previously or subsequently sold.