



Lead Free* Model DUCLF4N DUAL CHECK VALVE

SPECIFICATIONS

The **Lead Free*** Apollo® Model DUCLF4N (4NLF-300) Dual Check Valve prevents backflow by either backpressure or back-siphonage from a cross-connection between potable water lines and substances that are objectionable, but not health hazards.

FEATURES

- **Lead Free*** AB 1953 Certified
- Corrosion resistant
- Replaceable check modules
- Available in standard and swivel connections
- **MADE IN THE USA**

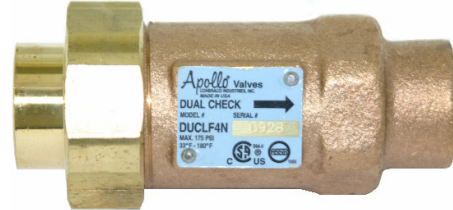

APPROVALS

ASSE® 1024 and CSA® B64.6
ANSI 3rd Party Approval to AB 1953 0.25% Lead Max

PERFORMANCE RATING

Maximum Continuous Operating Pressure 175 psi
Temperature Range 33 °F – 180 °F

MATERIAL SPECIFICATIONS

Part Name	Material
Body	Lead Free* Bronze C89836
Tailpiece	Lead Free* Brass C27450
Union Nut	Brass C36000
Check Modules	Glass-Filled Noryl® (3/8"-1/2") Acetal (3/4"-1")
Springs	Stainless Steel
Seat Discs	EPDM (3/8"-1/2") Buna-N (3/4"-1")

DIMENSIONS (in.) – WEIGHTS (lbs.)

Size	A	B	Wt.
3/8" & 1/2"	3.32	1.88	0.70
3/4"	4.38	2.00	1.40
3/4" Meter Swivel	4.75	2.00	1.60
1"	4.38	2.00	1.40
1" Meter Swivel	4.75	2.00	1.75

ORDERING INFORMATION

4NLF – 3 X X – X X



INLET CONNECTION^{1,3}

- A – FNPT
- B – MNPT
- C – Female Mtr Thd
- E – Male Meter Thd
- S – Female Mtr Swivel
- 2 – Female BSPP

SIZE²

- 2 – 3/8"
- 3 – 1/2"
- 4 – 3/4"
- 5 – 1"
- 6 – 1 1/4"

OUTLET CONNECTION^{1,3}

- A – FNPT
- B – MNPT
- C – Female Mtr Thd
- E – Male Meter Thd
- F – Female BSPP

Example: 4NLF-3S5-4A = 1" female meter swivel inlet (for connection to a 3/4" water meter) x 3/4" FNPT outlet.

Notes:

¹For meter threads, order one size larger than meter size.

²1 1/4" is only available for the Female Meter Swivel Connection.

³Not all inlet and outlet combinations are available. Please contact Conbraco Customer Service for availability.

Lead Free*: The wetted surfaces of this product shall contain no more than 0.25% lead by weighted average. Complies with AB 1953 and VT S.152. ANSI 3rd party certified and listed.

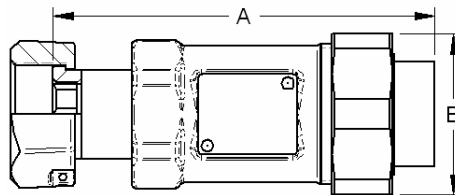
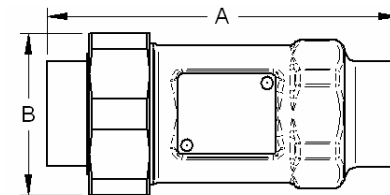

FLOW CURVES

